

```
size of-   text=xab90, data=x7bd3, bss=xdc71
```

```
Boot: Using default file:  
No default device available!
```

```
Boot: Cannot open defaults file:  
Boot: Using default file: hd(10,0)boot  
VTOC read error  
Open error
```

```
Boot: Cannot open defaults file: hd(10,0)boot  
Boot: Using console device: sr(0,B9600,C58)
```

```
Memory Dumper: dump.c 1.19 93/01/15 $  
WARNING: invalid nvrnm, reset dump device to hd(2)  
compact dump to device hd(2) with offset 0  
selecting pages to dump ...  
endless pageac list
```

```
Default Boot String is: hd(10,0)unix root=hd(1) swap=hd(2)  
Enter name of program to boot:
```

```
E NMI (FBFF) DEBUG address:00D800A0
```

```
:
```

- Hier ENTER drücken

Der MX300 bootlader fand nichts zu booten.

Sprung in den Monitor mit Drücken der [?] Taste

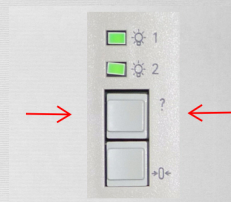

Boot: Using console device: sr(0,B9600,CS8)

Memory Dumper: dump.c 1.19 93/01/15 \$

WARNING: invalid nvram, reset dump device to hd(2)

compact dump to device hd(2) with offset 0

selecting pages to dump ...

endless pageac list

Default Boot String is: hd(10,0)unix root=hd(1) swap=hd(2)

Enter name of program to boot:

E NMI (FBFF) DEBUG address:00D800A0

:

SNI Firmware - D566 Version 3.7 92/06/15 *****

List of available Help pages

sy?	Symbols used in commands
TS?	Teleservice commands
SI?	SINIX commands for boot- and kernel-location
u?	Utilities page
t?	Test commands and tools page
io?	I/O system commands

: _

io?

I/O system commands

: sy?

Symbols

@	=	address in hex
#	=	number contextdependent
~	=	condition- & command-dependent s.t?
L	=	length in bytes
C	=	hex-character
(...)	=	(unit,offset in [s]#)(memory-@,length-#) s# offset in sectors ,# offset in K-Bytes

unitnumber layout:

0000 = 4 digit hex number (leading zeros are redundant)

- IIII> partition: addressable parts on 1 unit (like floppy and disk)
- III> unit: physical unit (like floppy drive, disk drive, LUN with SCSI) connected to a device
- II> device: SCSI ID (up to 7 units may be connected to 1 SCSI ID)

- I> controller: currently not used. *C is doing the job.

ATTENTION! The unit number is now interpreted as a hex number!
(f.e. FL0 is now 20 not 32 anymore).

:

io? I0 system commands

:

SNI Firmware - D566 Version 3.7 92/06/15 *****

List of available Help pages

sy? Symbols used in commands

TS? Teleservice commands

SI? SINIX commands for boot- and kernel-location

u? Utilities page

t? Test commands and tools page

io? I0 system commands

: TS?

Teleservice

TS?	this help
TSe [d]	TS enable [with default param, set WFC]
TSd [d]	TS disable [clear WFC]
TSI	TS interfacelines states (break with DEL)
TSp[?] [i1 i2 i3]	TS parameters [info,help] [ind1 ind2 ind3]
TShs[?] [string]	TS handshake signals [info,help] [param]
TSf[?] [string]	TS condition flags [info,help] [param]
res[e,d]	Reset with BREAK [enable,disable]

: _

t? Test commands and tools page

io? I/O system commands

: SI?

SINIX commands

bootloc string	define Systemboot location
bootdr drivetype	define Systemboot drive
bootloc?	print the defined location and the location the firmware booted from
sinixloc string	define the kernel location
sinixloc?	print the defined kernel location
SI?	this help

If string contains more than 1 command, enclose string in ""

valid drivetypes:

0: 5 1/4" DD-Floppy, 0mti	1: 5 1/4" DD-Floppy
2: 5 1/4" SD/DD-Floppy	3: 3 1/2" ND-Floppy
4: 5 1/4" HD-Floppy	5: 3 1/2" HD-Floppy
6: Harddisk (ESDI)	7: Harddisk (ST506)
8: Streamer (QIC)	9: SCSI Floppy
10: SCSI Harddisk	11: SCSI Streamer
12: SCSI CD-ROM	13: invalid

: -

: u?

Utilities

passwd	change the firmware password
[l,,r,w](...)[(...)]	load, load-start, read, write dsk,fl,str
D(...)	Display dataoffset in x.out-file
;	cat commands
<END>	return(1)
K?[#]	display[startnumber]
K#	start command with index #
ai	display icu registers
ci # [0,1] #	change icu reg index [addr] value
in[e,d]	interrupts [enable,disable]
cm[b,w,d] @ #	change memory [byte,word,double] addr data
D [a,K#] [#]	display string [addr,comm] [stringcount]
d @ L	display memory
d[b,w,d]~ @ L	display memory, endless. LOOP must be set
f[b,w,d]~ @ @ C	fill memory. With LOOP set, endless.
s[=,s,m][, ,b,w,d] @ @ L	string[~comp,seek,move][byte,word,double]
smb [K#,a] [K#,a] L	string move with command strings
P	printer on/off
kb[g,i]	keyboard at 97801 [german,international]
dt @	transfer data in 'intel hex' format to address
q (quit), CR (1 line), d (11 lines), space (21 lines)	

cm[b,w,d] @ #	change memory [byte,word,double] addr data
D [@,K#] [#]	display string [addr,comm] [stringcount]
d @ L	display memory
d[b,w,d]~ @ L	display memory, endless. LOOP must be set
f[b,w,d]~ @ @ C	fill memory. With LOOP set, endless.
s[=,s,m][, ,b,w,d] @ @ L	string[~comp,seek,move][byte,word,double]
smb [K#,@] [K#,@] L	string move with command strings
P	printer on/off
kb[g,i]	keyboard at 97801 [german,international]
dt @	transfer data in 'intel hex' format to address via DUART chan 1. Parameters see iop?
ph[s,c,?]	powerhold FF [set,clear,test]
x[,?] [#]	[set,show] cond. switch (0: reset, else: !=)
0x0100	no status print
^	position to line 24 on screen
mbra # #	set the multibus window
mb? [@ @]	mb window/mapper info [mbstart mbend]
mbm [@ @ [@ [#]]]	mb map set. mbstart mbend [phys_start [inval]]
mb[e,d]	mb map [enable,disable]
reset	do reset
pof	poweroff
scsidevices	generate list of connected scsi bus devices
scsibusreset	reset on the scsi bus, scsi driver reinit

ph[s,c,?]	powerhold FF [set,clear,test]
x[,?] [#]	[set,show] cond. switch (0: reset, else: !=)
0x0100	no status print
^	position to line 24 on screen
mbra # #	set the multibus window
mb? [a a]	mb window/mapper info [mbstart mbend]
mbm [a a [a [#]]]	mb map set. mbstart mbend [phys_start [inval]]
mb[e,d]	mb map [enable,disable]
reset	do reset
pof	poweroff
scsdevices	generate list of connected scsi bus devices
scsibusreset	reset on the scsi bus, scsi driver reinit

SNI Firmware - D566 Version 3.7 92/06/15 *****

List of available Help pages

sy?	Symbols used in commands
TS?	Teleservice commands
SI?	SINIX commands for boot- and kernel-location
u?	Utilities page
t?	Test commands and tools page
io?	I/O system commands

: t?

Test tools

tr1 @ @ #	mem-probe start end step (switch caches off!)	
tr2[b,w,d] @ L #	~memory test, write all, read all	
tr3[b,w,d] @ L #	~memory test, test address for address	
tr4 @ #	RAS/CAS relations bankaddr cycles	
tcpulock	Testing locked cpu-memory rmw cycles (special)	
ter2 @ L #	edc ram test, write all read all	
ter3 @ L #	edc ram test, test address for address	
tma[3] #	~test the mapper memory, [similar to t3]	
mb[m,?] [@ @ [@ [#]]]	mb map set. mbstart mbend [phys_start [valid]]	
tcl	testing ram, registers and run of the clock	
tic	testing the icu	
x[,?] [#]	[set,show] cond. switch (0: reset, else: !=)	
0x1 Trigger	0x4 LOCK	0x10 MMU_ST
0x2 iolock	0x8 LOOP	0x100 no status print
tethprom	D566: test the ethernet prom	
tlan #	D566: test the lan chip i82596	
0	controller selftest	
1	0 + initialize test	
2	1 + register dump test	

q (quit), CR (1 line), d (11 lines), space (21 lines)_

tr1 @ @ #			mem-probe start end step (switch caches off!)
tr2[b,w,d] @ L #			~memory test, write all, read all
tr3[b,w,d] @ L #			~memory test, test address for address
tr4 @ #			RAS/CAS relations bankaddr cycles
topulock			Testing locked cpu-memory rmw cycles (special)
ter2 @ L #			edc ram test, write all read all
ter3 @ L #			edc ram test, test address for address
tma[3] #			~test the mapper memory, [similar to t3]
mb[m,?] [@ @ [@ [#]]]			mb map set. mbstart mbend [phys_start [valid]]
tcl			testing ram, registers and run of the clock
tic			testing the icu
x[,?] [#]			[set,show] cond. switch (0: reset, else: !=)
0x1 Trigger	0x4	LOCK	0x10 MMU_ST
0x2 iolock	0x8	LOOP	0x100 no status print
tethprom			D566: test the ethernet prom
tlan #			D566: test the lan chip i82596
0			controller selftest
1			0 + initialize test
2			1 + register dump test
3			2 + TimeDomain Reflectometer (TDR) test
tscsi			D566: test the scsi controller chip 53C710

:

List of available Help pages

sy? Symbols used in commands
TS? Teleservice commands
SI? SINIX commands for boot- and kernel-location
u? Utilities page
t? Test commands and tools page
io? IO system commands

: io?

IO system commands

io? this help
ioe # io enable desc
iod # io disable desc
iop[?] # [i1 i2 i3] io parameters [info,help] desc [ind1 ind2 ind3]
iohs[?] # [string] io handshake signals [info,help] desc [param]
iol # io lines desc (break with DEL)
 valid descriptors:
 0: Console
 2: Printer

coid[?] [#] console id [info] [index]

:

```
io?                this help
ioe #             io enable desc
iod #             io disable desc
iop[?] # [i1 i2 i3]  io parameters [info,help] desc [ind1 ind2 ind3]
iohs[?] # [string]  io handshake signals [info,help] desc [param]
iol #             io lines desc (break with DEL)

    valid descriptors:
    0: Console
    2: Printer
```

```
coid[?] [#]       console id [info] [index]
```

:

```
SNI  Firmware - D566  Version  3.7      92/06/15  *****
```

List of available Help pages

```
sy?               Symbols used in commands
IS?               Teleservice commands
SI?               SINIX commands for boot- and kernel-location
u?               Utilities page
t?               Test commands and tools page
io?              IO system commands
```

:

_